

DETALHE DA TESOURA DO TELHADO 01

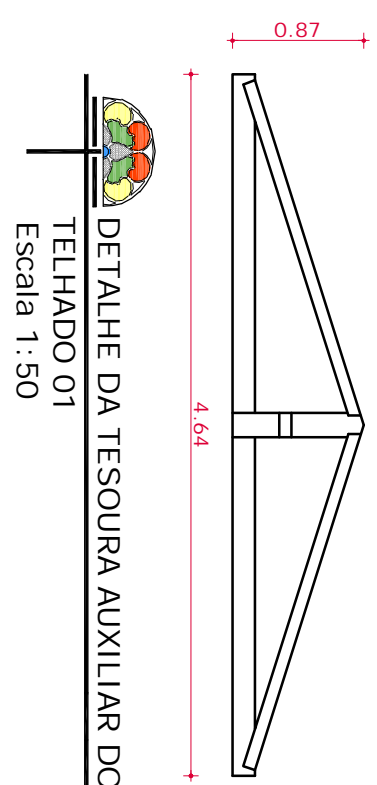

DETALHE DA TESOURA AUXILIAR DO
TELHADO 01
Escala 1:50

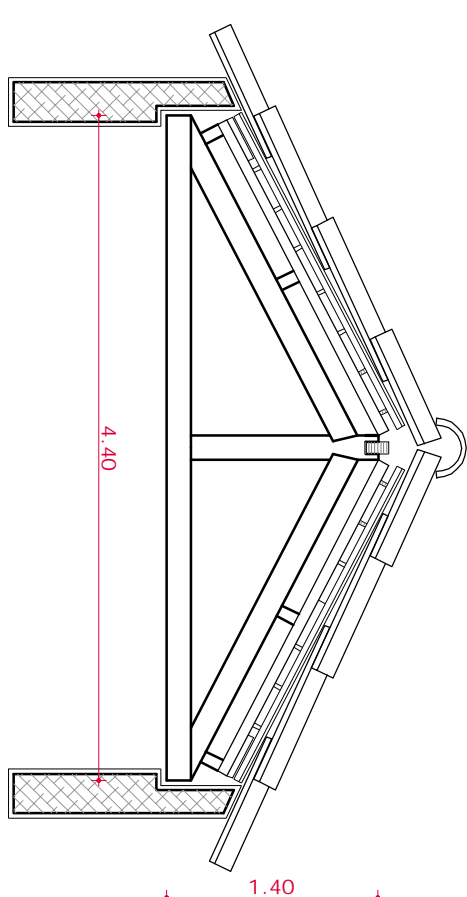

DETALHE DA TESOURA DO TELHADO 02

Escala 1:50

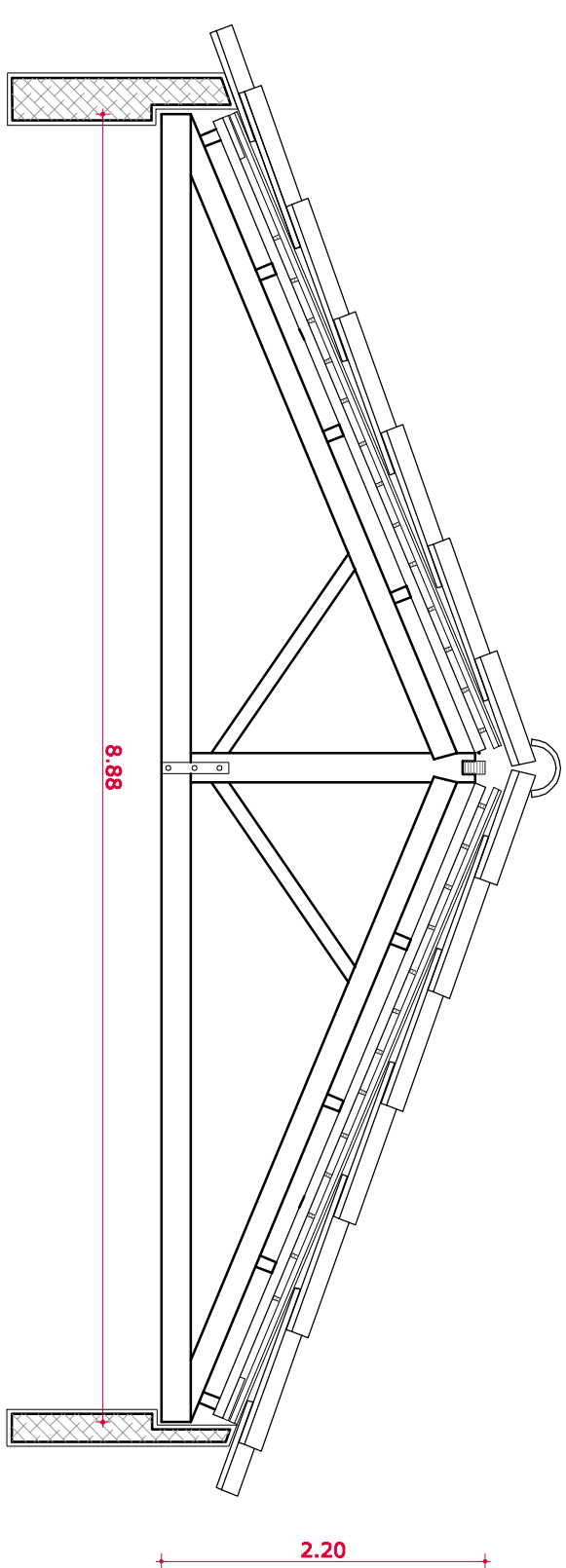

DETALHE DA TESOURA DO TELHADO 03

Escala 1:50

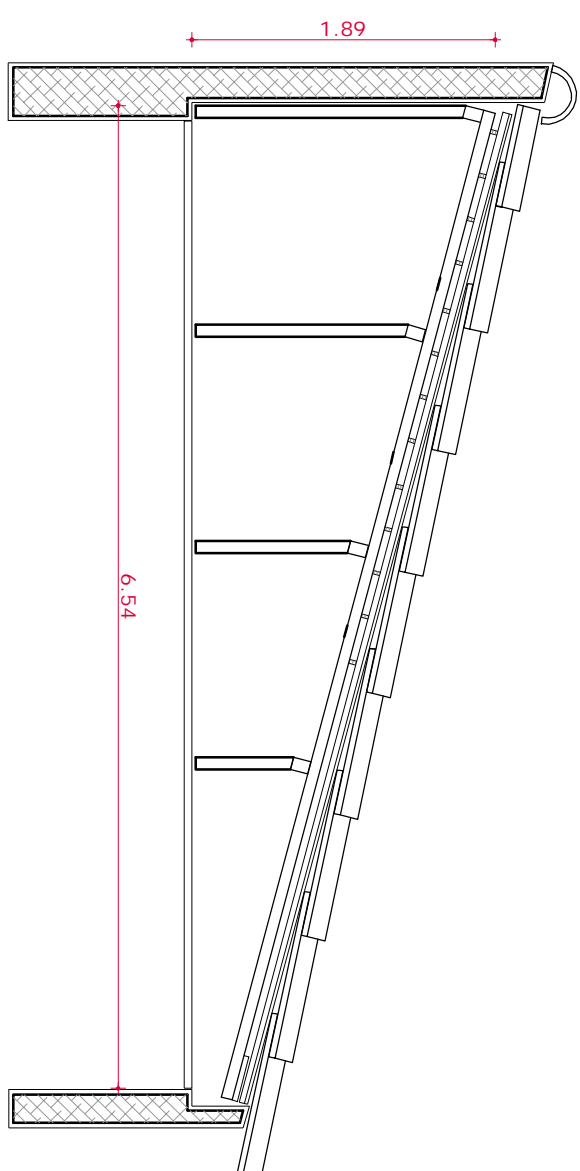

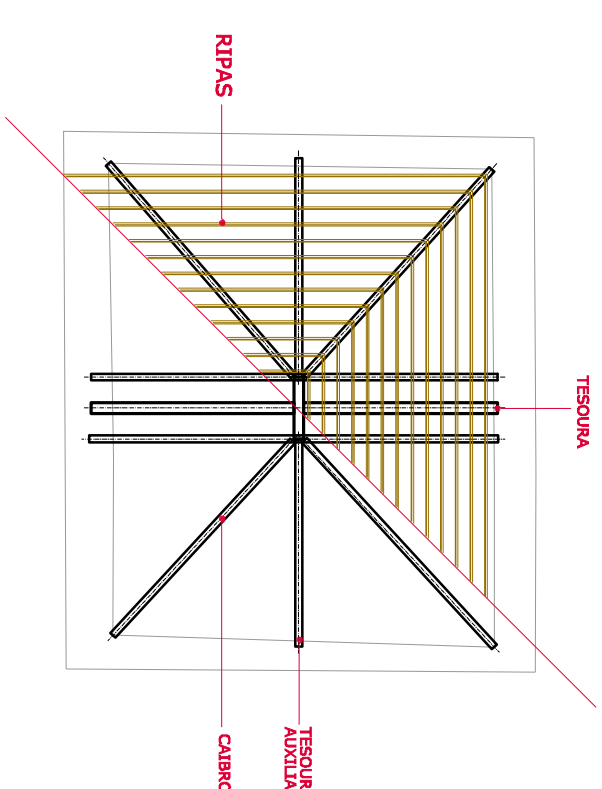

DETALHE DA TESOURA DO TELHADO 04

Escala 1:50

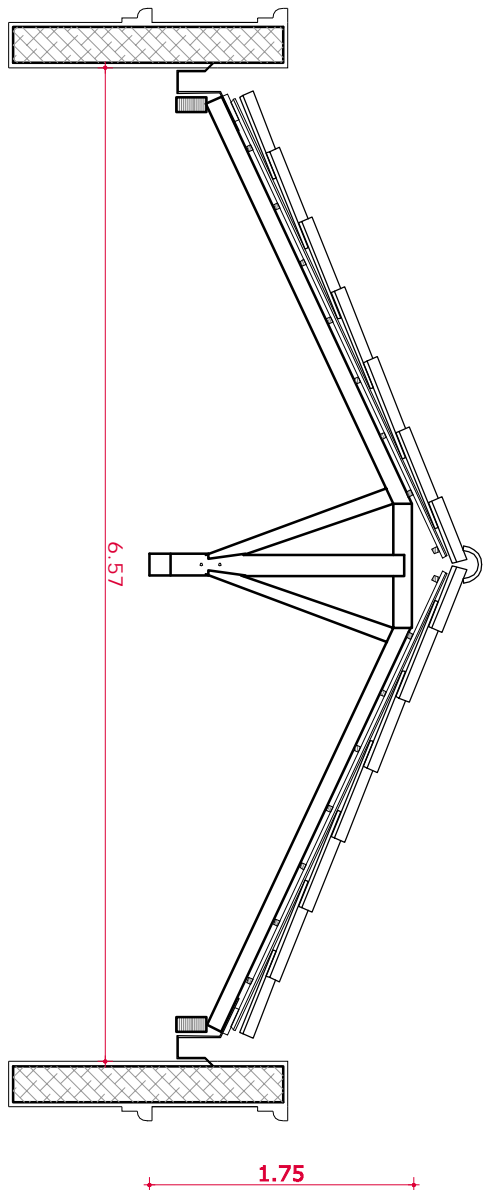

PLANTA DE ESTRUTURA DA COBERTURA
TERCEIRO PAVIMENTO
Escala 1:100



 DETALHE TESOURA AUXILIAR DO
 TELHADO 06
 Escala 1:50

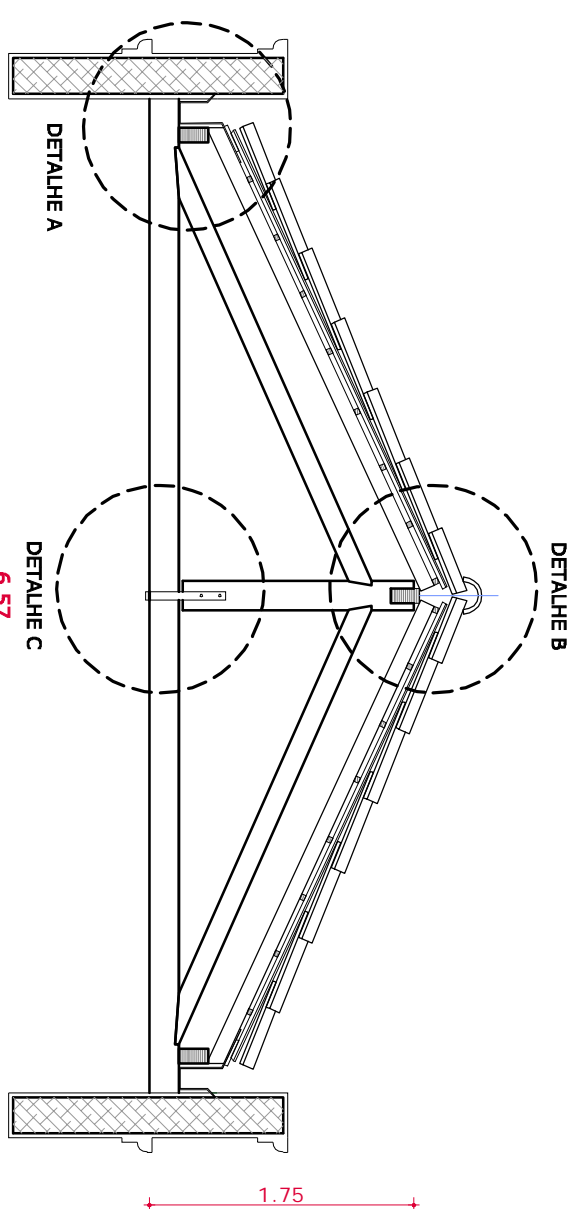

DETALHE DA TESOURA DO
TELHADO 06
Escala 1:100

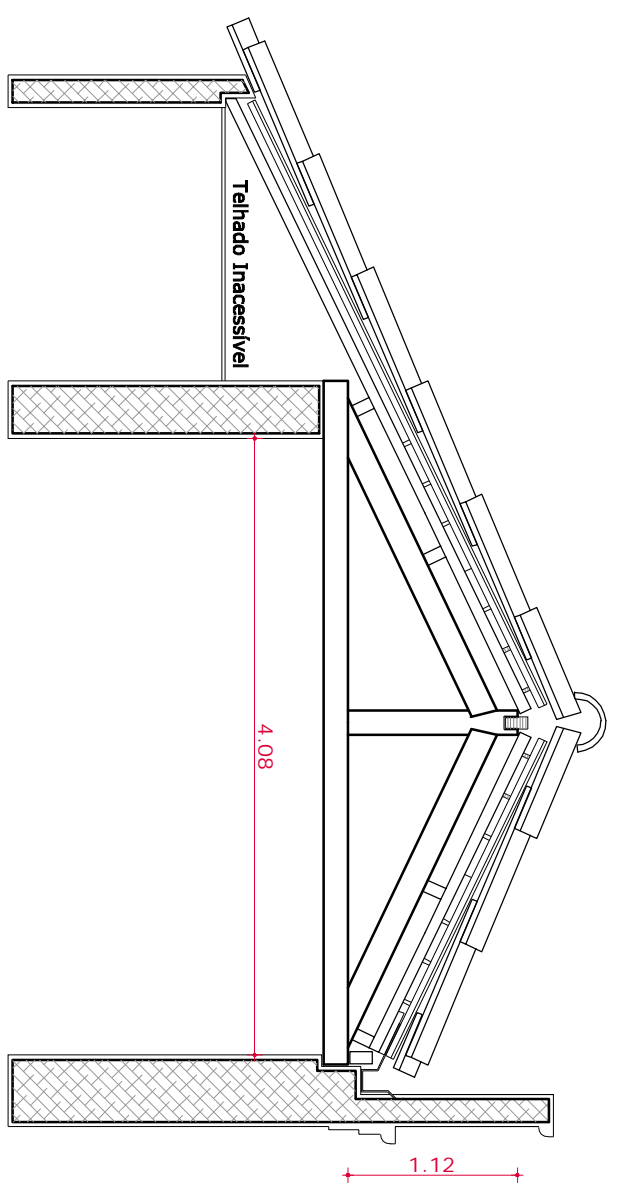

DETALHE DA TESOURA DO TELHADO 05

Escala 1:50

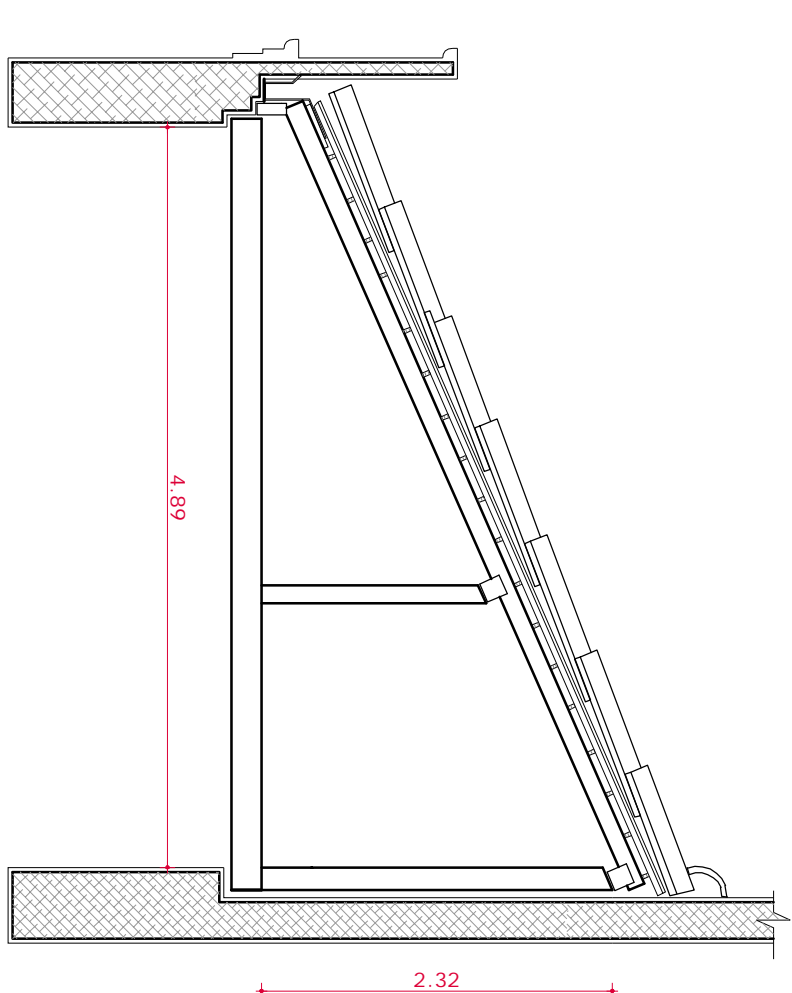

DETALHE DA TESOURA DO TELHADO 07

Escala 1:50

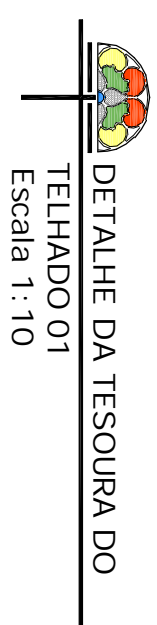

DETALHE DA TESOURA DO
TELHADO 01
Escala 1:10

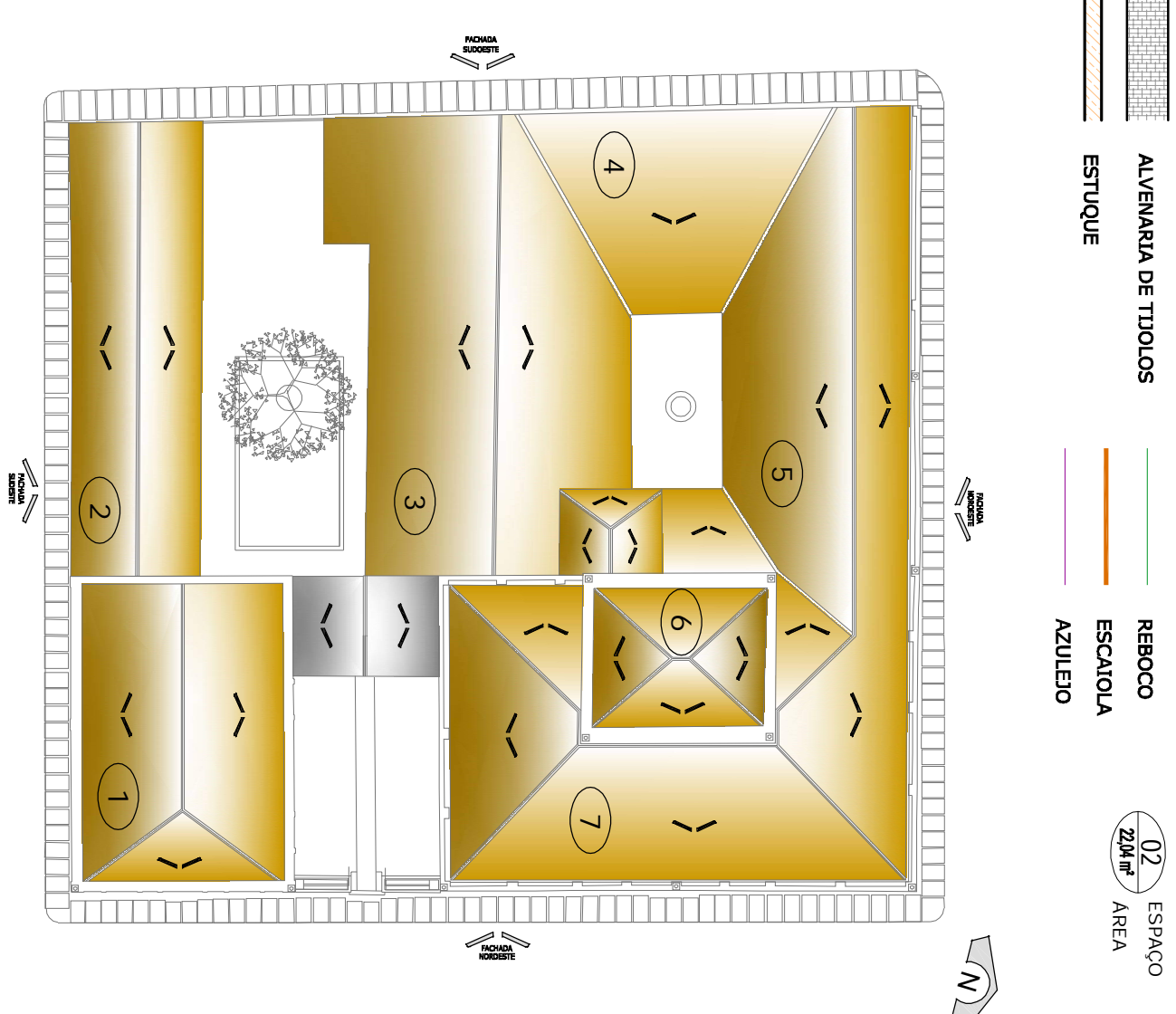
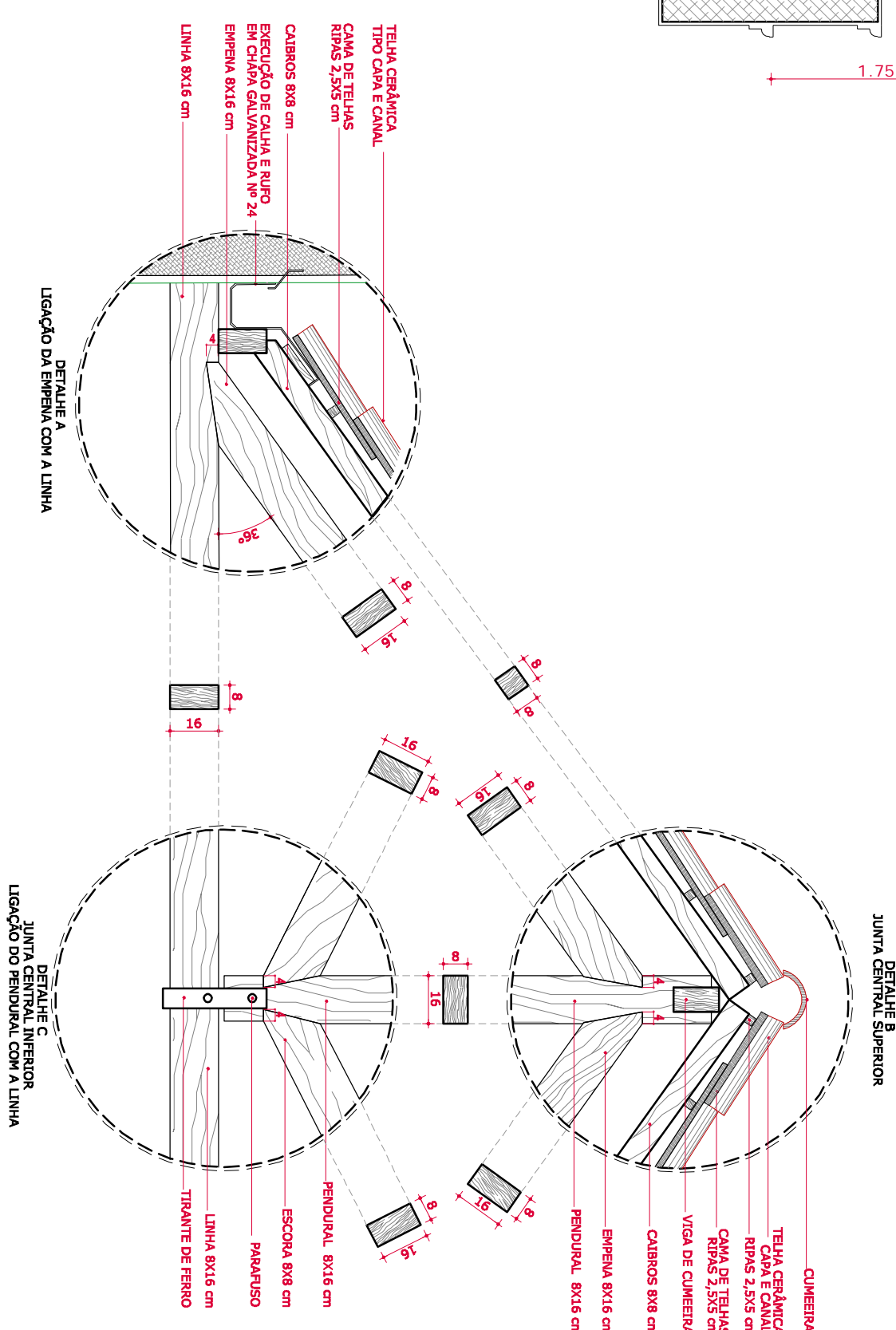

LEGENDA

COTAS E NÍVEIS EM METROS

CONVENÇÕES

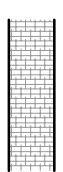

ALVENARIA DE TIJOLOS



ESTUQUE





REBOCO



ESTIMATING
AREA

RESERVADO PARA APROVAÇÕES

 <h1>PROGRAMA DE RECUPERAÇÃO DO MUSEU DA BARONESA</h1>	
<h2>MUSEU DA BARONESA</h2>	
RUA Prefeitura Municipal de Pelotas	LOCAL
Av. Domingos de Almeida, 1490	ENDEREÇO
Planta de Estrutura da Cobertura	IMAGEM Museu da Baronesa
AUTORIA 	TÍTULO Levantamento Cadastral
R. Rául Dornel Mendes Catarino 501-505-506	DATA Novembro de 2018
Eng. Gisela de Albuquerque Frattini 505-506-507	ESTADO Indicado
ANA 902,11 m²	PERÍMETRO 